

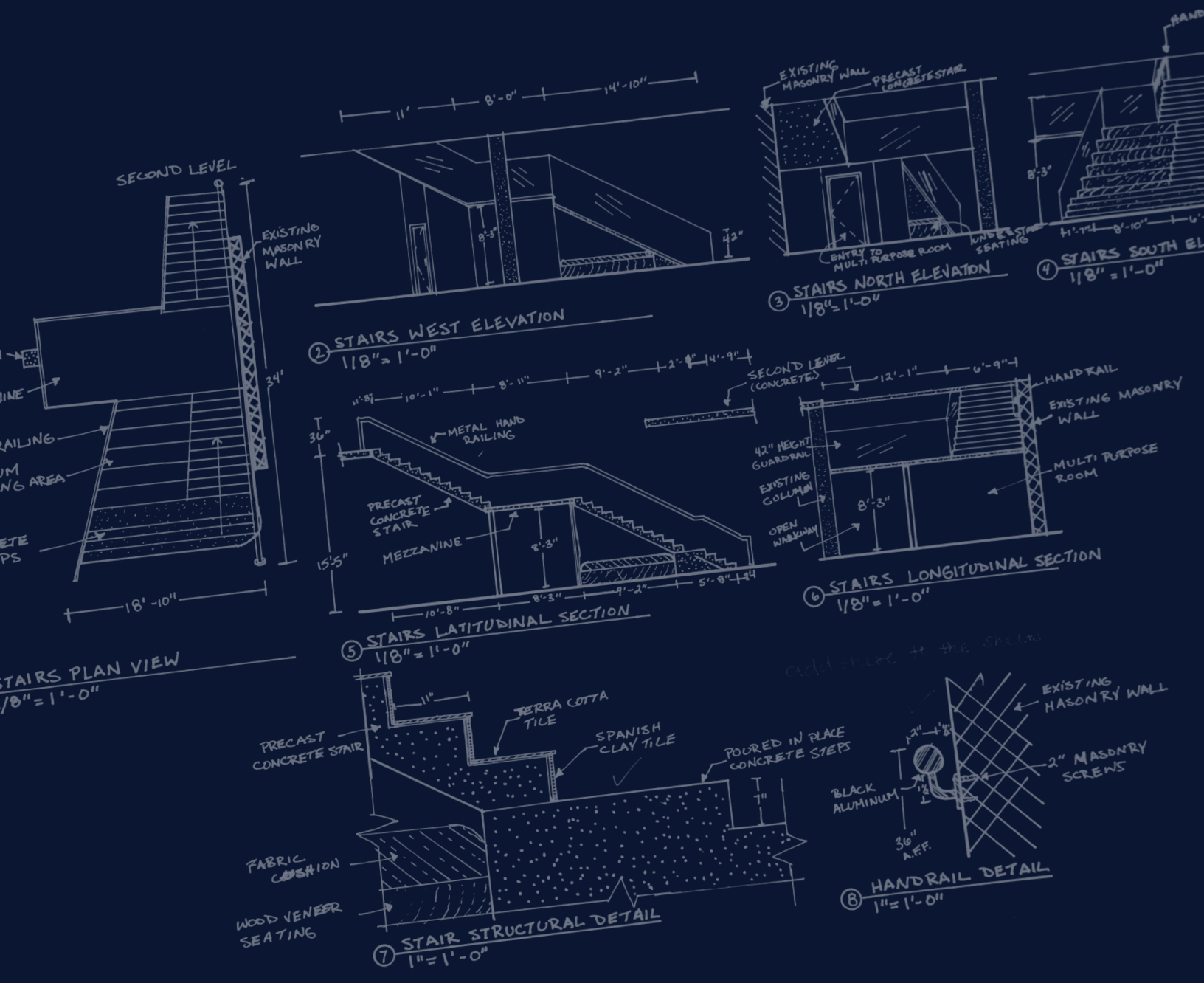

PORTFOLIO  
GABRIEL FERNANDEZ



“DESIGN IS THE INTERMEDIARY BETWEEN INFORMATION AND UNDERSTANDING.”  
 — RICHARD GREFFÉ



Thank you for taking the time to review a selection of my favorite works from the past few years. I hope you enjoy viewing these projects as much as I did working on them! To see even more details of these projects, and several others, please visit my website at [www.gfdesigned.com](http://www.gfdesigned.com).

*Galvin Ferrer*

# TABLE OF CONTENTS



*Workplace*  
4-7

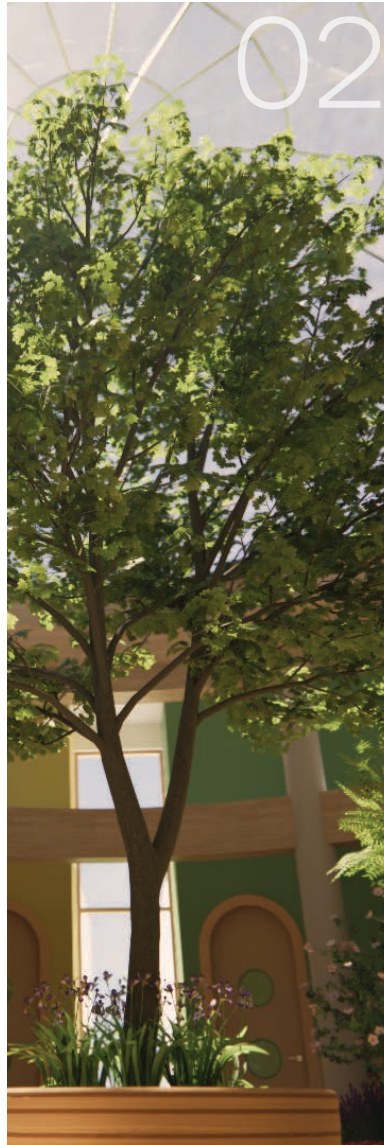

*Education*  
8-11



*Healthcare*  
12-15



*Lighting Design*  
16-17

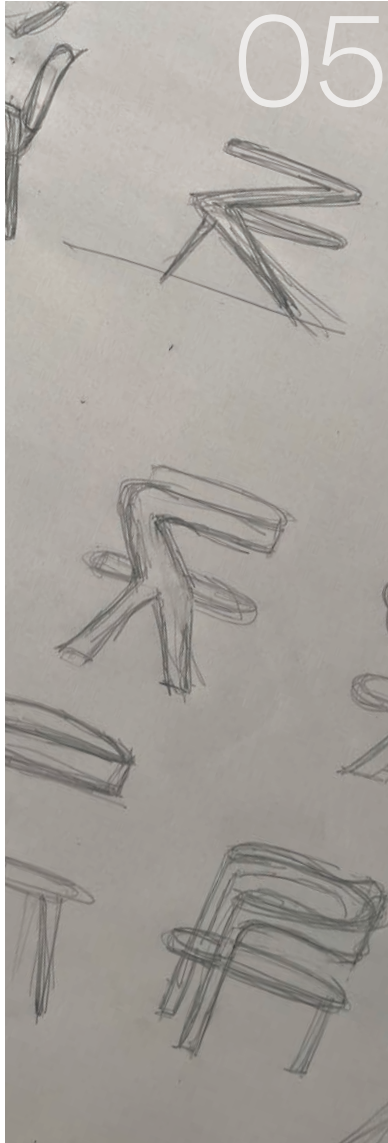

*Furniture Design*  
18-19



*Sketches*  
20



Client: WhatsApp  
Location: 620 Brickell World Plaza, Miami, Florida 33131  
Size: 7,672 Sq. Ft.  
Year: 2024  
Team: Individual Work



*workplace*

## WHATSAPP MIAMI OFFICE SPACE

Design Criteria: Design an office space for a social media company in an existing Brickell office building, utilizing design to address current company concerns.

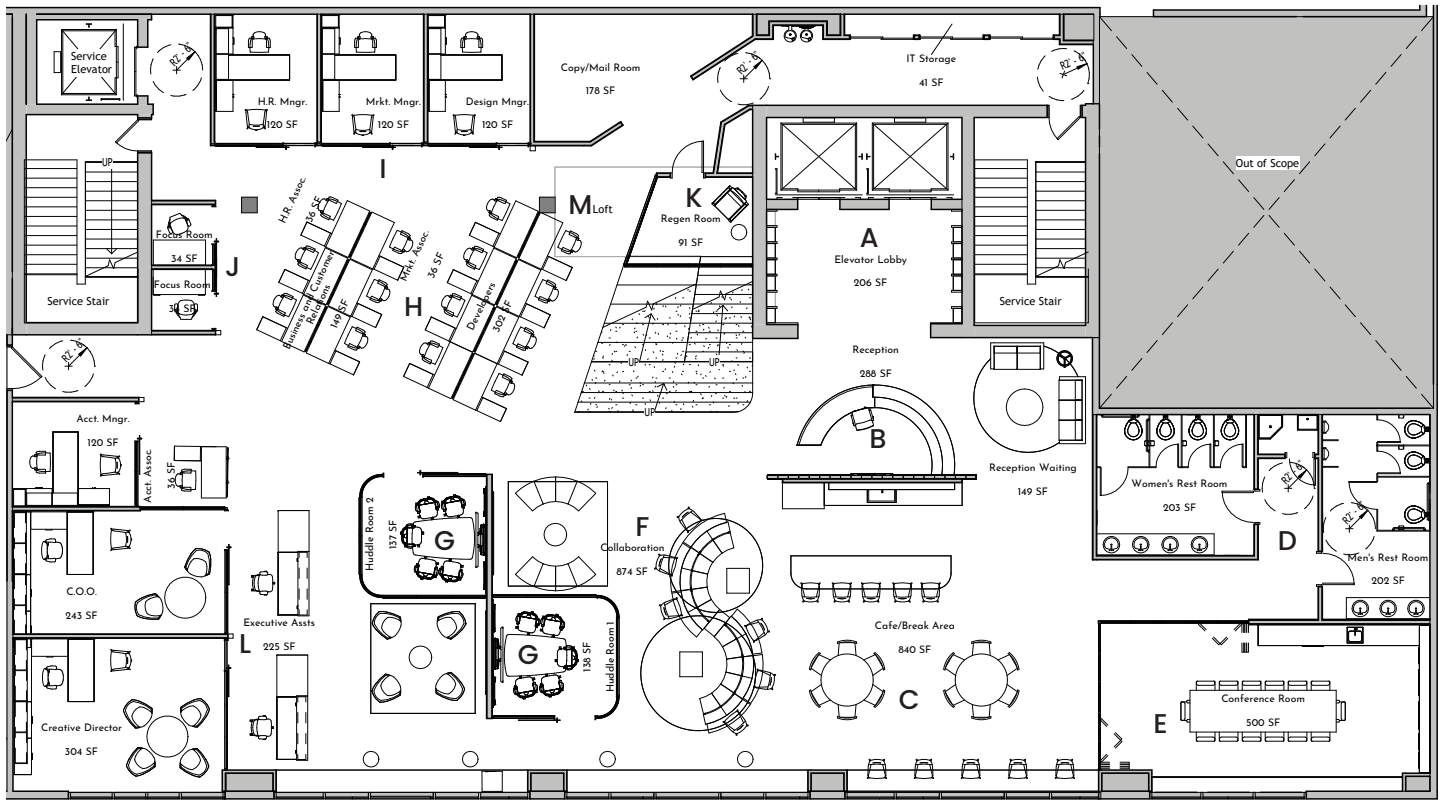

- |   |                          |   |                        |
|---|--------------------------|---|------------------------|
| A | Entry Lobby              | H | Open Workspaces        |
| B | Reception                | I | Management Offices     |
| C | Employee Break Area/Cafe | J | Focus Rooms            |
| D | Restrooms                | K | Restorative/Quiet Room |
| E | Conference Room          | L | Executive Offices      |
| F | Collaboration Area       | M | The Loft               |
| G | Huddle Rooms             |   |                        |





Brickell, as home to many of the Latin American headquarters and regional offices of large companies, is widely considered “the gateway to Latin America”. WhatsApp is the largest messaging app in South America, used to connect people across the world. Therefore, in an effort to create a sense of warmth, home, connection, and ownership among employees, the office space is designed with an eye towards traditional “Miami” and Latin design elements. Within the limited footprint of the space, each employee is provided with their own personalizable work area. Further, there are several collaborative spaces that can accommodate the entire office workforce down to a meeting of just a few people. We have even provided private quiet spaces to offer employees much needed space to retreat for virtual meetings or a moment of mental restoration.

Scan for Virtual Walk Through





Client: The Link Center for Children with Autism  
Location: 3661 S Bayshore Dr., Miami, Florida 33133  
Size: 7,000 Sq. Ft.  
Year: 2025  
Team: M. Roca



*education*

## THE LINK CENTER FOR CHILDREN WITH AUTISM

Design Criteria: Design a building and interior space within an existing empty lot to provide for the needs of an underserved and vulnerable population.

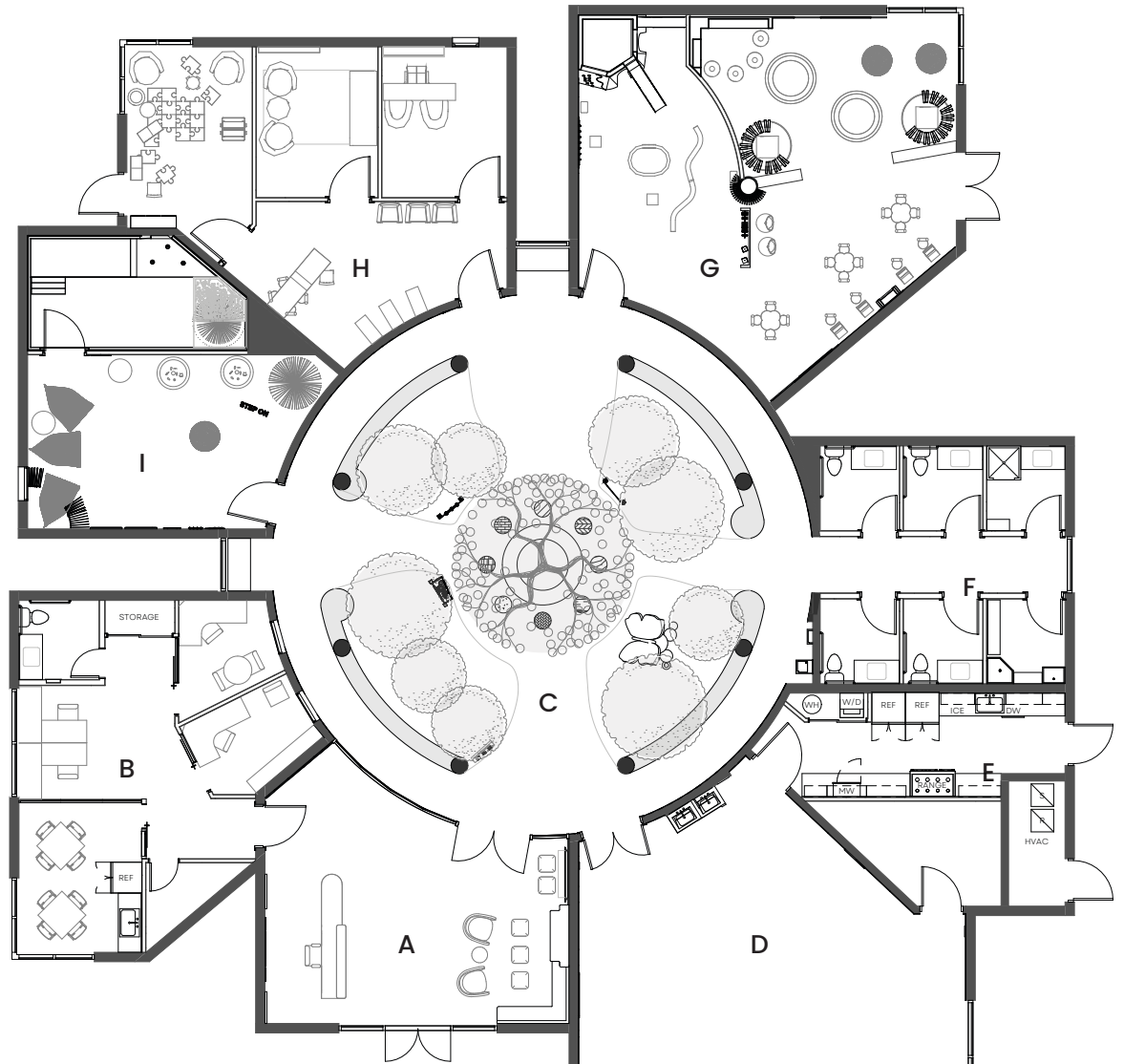

- |   |                   |   |                |
|---|-------------------|---|----------------|
| A | Lobby & Reception | F | Restrooms      |
| B | Office            | G | Play Room      |
| C | Sensory Atrium    | H | Therapy Area   |
| D | Multipurpose Room | I | Snoezelen Room |
| E | Kitchen           |   |                |





The location was chosen strategically for its proximity to Mercy Hospital facilities, ample parking, access to public transportation, and adjacency to water views and green spaces. Containing 7,000 square feet of controlled sensory experiences, group play spaces, quiet rooms, one-on-one and group therapy rooms, a sensory atrium, multipurpose and conference rooms, The Link student center is acutely focused on the developmental needs of young children with Autism Spectrum Disorder. The variety of spaces allows program administrators to meet the children – and their caregivers – where they are in their journey to best suit their needs. The relatively simple layout is designed to be approachable and easy to navigate but offers ample choices and flexibility for individuality. By integrating chances for tactile learning, motor skill development, and controlled sensory experiences, these young students can grow at their own pace. Through creation of a space for students ranging from five to ten years old, we hope to provide a nurturing environment that can bring together educators, students, parents, and caregivers to form wellness in community; for not only the students but the entire family as well.

Scope of responsibility: Lobby, Office, Sensory Atrium, Multipurpose Room, Kitchen, exterior and site

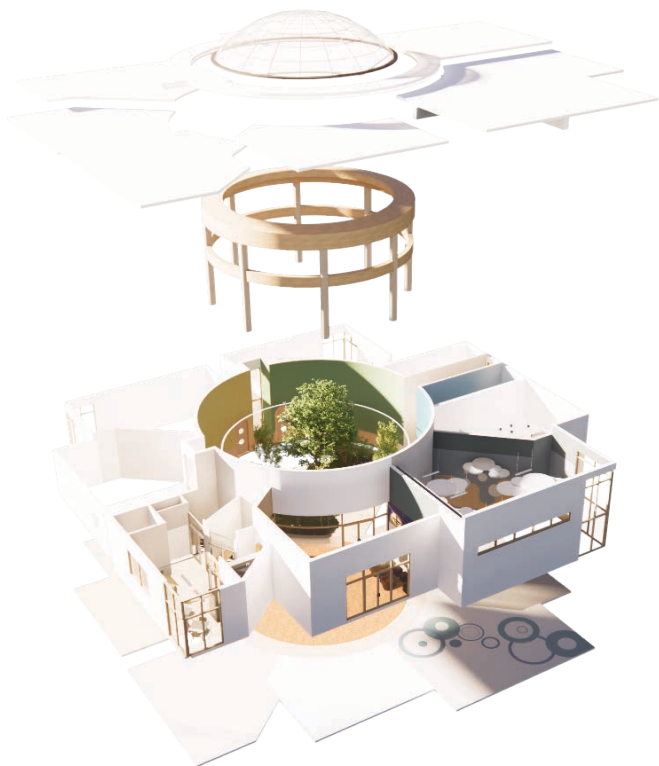



Client: Aventura Hospital  
Location: 20900 Biscayne Blvd, Aventura, Florida, 33180  
Project Size: 20,720 Sq. Ft.  
Year: 2025  
Team: G. Pi, T. Vallejos



*healthcare*

## AVENTURA HOSPITAL EMERGENCY DEPARTMENT EXPANSION

Design Criteria: Design an expansion of the Emergency Department at Aventura Hospital primarily for walk-in patients.



Designed primarily for walk-in emergency care, we wanted this extension to have a grounded, warm, and light feeling. Inspired by old growth forests, we utilized a palette of deep greens and wood tones meant to invoke stability and a surrounding comfort. Bright yellows are used to highlight important landmarks, such as check-in desks and nurse's stations, much like a beam of sunlight through a forest would. The registration and waiting areas are intended to allow patients and visitors to create a sense of privacy for themselves, while also allowing visibility of all areas. Utilizing the furthest portion of the waiting area as a marketplace (equipped with modern food and drink cooler vending) and a small café, instead of a traditional vending machine room, gives family members, who may be waiting for an extended time, a variety of seating options and freedom to move about, while not straying far from the emergency department entrance. The design also provides two triage rooms with a secondary triage waiting area, two isolation exam rooms, two mental health exam suites, twenty standard exam rooms, and six nurses' stations with access to medication cabinets, equipment, clean rooms, and soiled rooms. A large staff break area provides employees with a full kitchen, staff-only restrooms with changing rooms and lockers, and three resting pods. We placed focus on designing for the needs of not only the patients, but also for the care providers and patient's families. Through this, we hope to have created spaces that foster health, healing, and wellbeing.

Primary scope of responsibility: Entrance, Reception and Security, Registration, Waiting Area, Marketplace, Children's Play Space, Triage Rooms, and Secondary Triage Waiting Area.

- A Reception & Security
- B Wheelchair Storage
- C Waiting Area
- D Registration
- E Triage
- F Triage Waiting Room
- G Family Room
- H Restrooms
- I Mech/IT Rooms
- J Marketplace/Cafe
- K Children's Play Area
- L Staff Lounge
- M Exam Rooms
- N Nurses Stations





*lighting design*

## ADAPT SCONCE MODEL

Design Criteria: Design and build a light fixture which allows for the adjustment of light intensity and direction

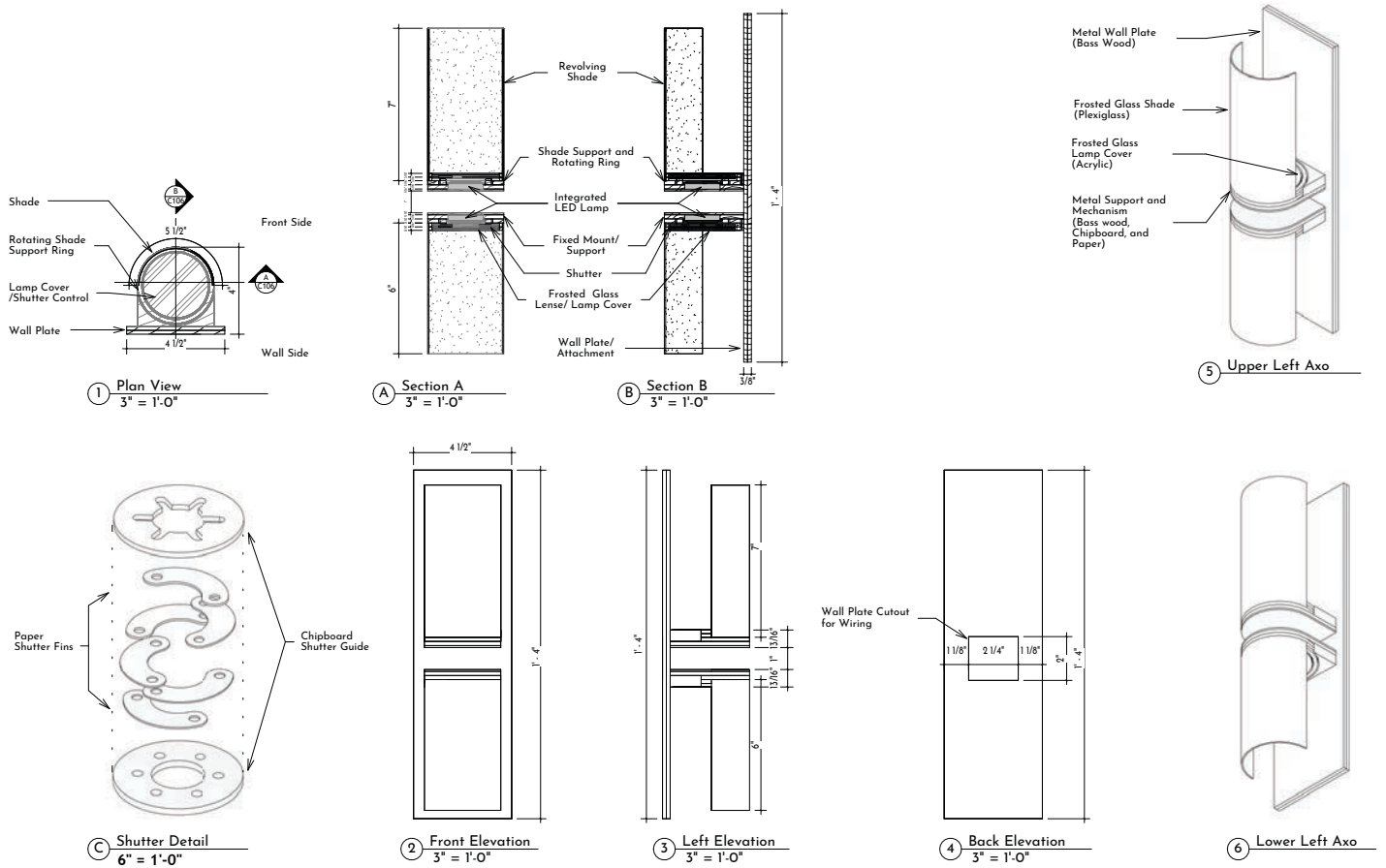

The Adapt wall sconce was created with two LED lamps shining up and downwards. Each light source has a controllable "shutter" system to manually and independently adjust the intensity of the illumination, while each lamp's translucent shade can rotate 360 degrees to alter the direction of light as desired. Model built with laser cut balsa wood and paper.

Designed: 2024

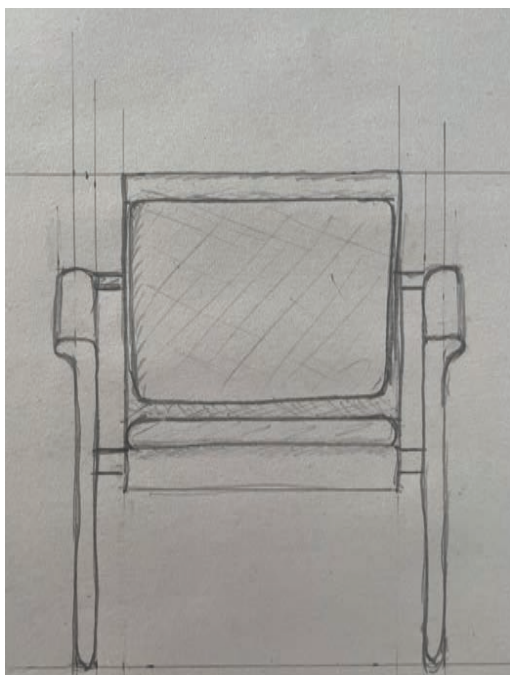

*furniture design*

## BENT WOOD LOUNGE CHAIR

This lounge chair is meant to evoke the simplicity of early 1900s bent wood forms popularized by Aalto and the Eames. CNC carved and sculpted wood legs surround and support the singular flowing sheet which forms the seat and backrest. Formed using seven sheets of plywood pressed and molded together, the seat is sized, angled, and curved to maximize comfort.

Designed: 2025



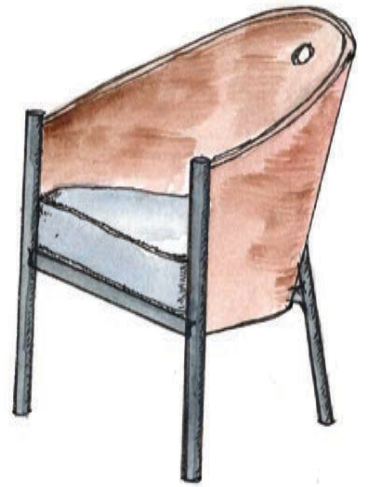
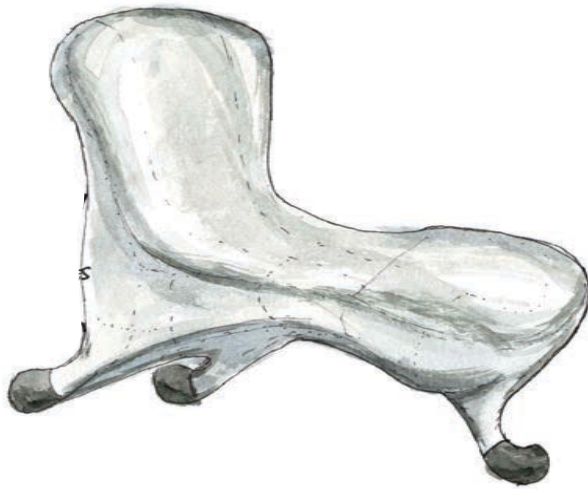

*sketches*

## HISTORICAL CHAIR STUDIES

Sketches of historical furniture pieces. Watercolor and pen on paper.

Clockwise from top left:

- Jean Prouve, Chair No. 350, 1968
- Marc Newson, Lockheed Lounge, 1990
- Phillipe Starck, Costes Chair, 1984
- Robert Venturi, Queen Anne, 1983
- Terry Farrell, TVAM Chair, 1982
- Arne Jacobson, Egg Chair, 1958

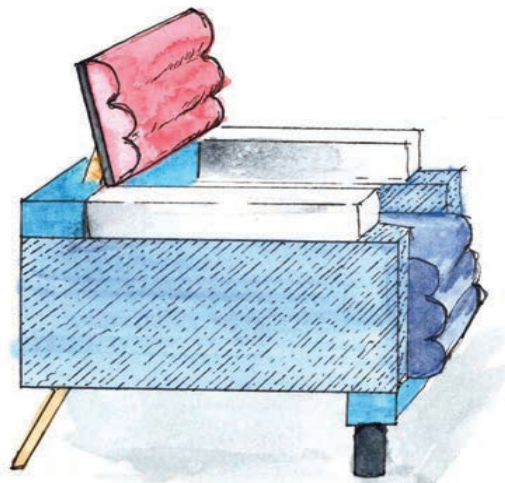
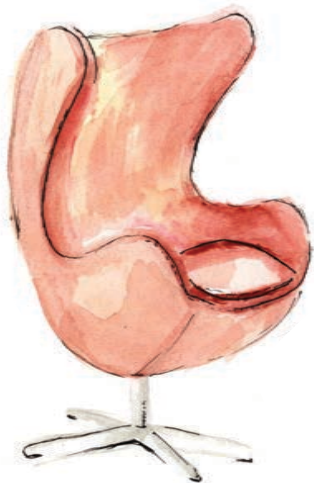





[WWW.GFDESIGNED.COM](http://WWW.GFDESIGNED.COM)

